

Imation

# Black Watch™ 9840

## Half-Inch Tape Cartridge

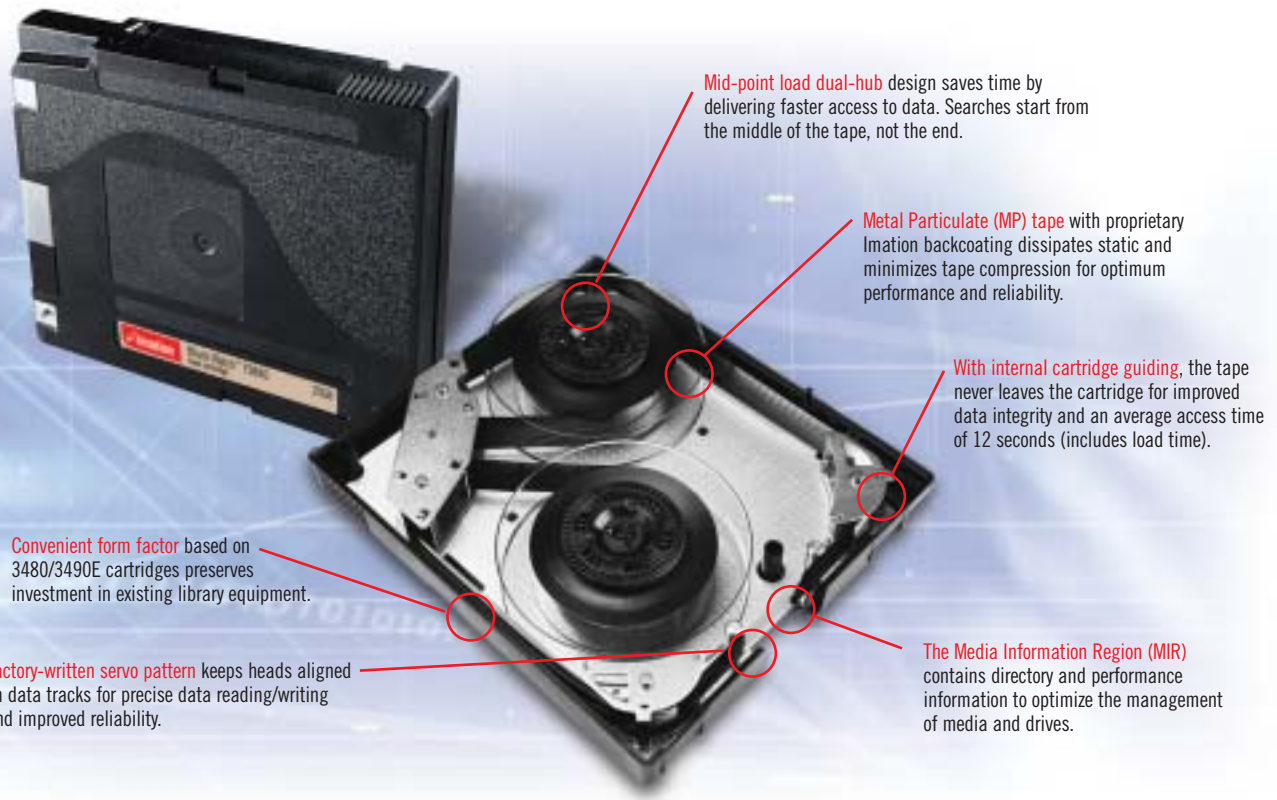

### Fast, Hardworking, Reliable

In business today, information access and capacity demands are a growing challenge for efficient, cost-effective data management. Now, one storage technology radically redefines performance: 9840 half-inch tape technology. The Imation Black Watch™ 9840 Half-Inch Tape Cartridge is at the heart of the solution, with its revolutionary, totally internal tape path design and a familiar 3480-based form factor.

The 9840 tape cartridge draws on the long history of Imation half-inch tape development and combines “the best of the best” from current solutions with brand new innovations. Offering access speeds that rival random access, the Black Watch 9840 tape cartridge sets new standards for half-inch tape performance with proven enterprise-strength reliability.

### Speed

Access times are decreased to 12 seconds due to the dual hub, mid-point load design. The tape rides on a cushion of air that virtually eliminates friction between the tape and guides, enabling the fastest search speeds of any tape storage system.

### Performance

The 9840 is the only technology to contain a baseplate. This aluminum baseplate enhances cartridge stability and enables precise alignment between head and tape to ensure reliable data reading/writing.

### Reliability

Advanced servo-writing techniques enable 288 data tracks to be written across the half-inch wide tape.

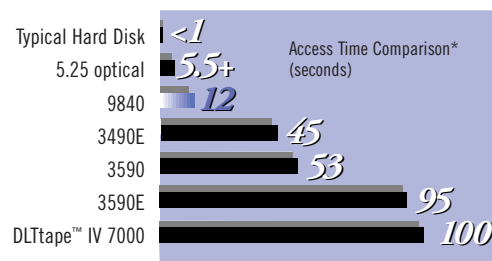

\*Based on average first access to data, including load time.

*9840 technology rivals random-access technologies by achieving unprecedented access times for half-inch tape.*



Imation Enterprises Corp.  
 1 Imation Place  
 Oakdale, MN 55128-3414  
 651 704.4000  
 888 466.3456 phone  
 800 537.4675 fax  
 www.imation.com  
 info@imation.com

Imation Canada Inc.  
 P.O. Box/C.P. 5440  
 London, Ontario  
 N6A 5Z6 Canada  
 888 466.3456 phone (tél)  
 888 864.2260 fax (télé)

Imation Corp. Latin America/  
 Africa Regional Offices  
 6205 Blue Lagoon Drive  
 Suite 600  
 Miami, FL 33126  
 305 460.7999 phone  
 305 460.7998 fax

## Imation 9840 Cleaning Cartridge



**Order Number: 51122-90676**

An efficient way to clean recording heads without dismantling your tape drive. Helps extend system life, minimize service calls and maintain reliability. Each cartridge provides 100 cleanings.

## Product Specifications

### Imation Black Watch™ 9840 Half-Inch Tape Cartridge 51122-91270

Physical Characteristics	
Substrate	Polyethylene naphthalate (PEN)
Capacity	20GB Uncompressed
Durability	
- Long Length	361 full-file writes/reads (7.2 terabytes) minimum (6,500 write/read passes)
- Short Length	80,000 write/read passes minimum
Magnetic Characteristics	
Coercivity	1625 ± 75 Oersted (130 ± 6.0 KA/m)
Cartridge Mechanical Characteristics	
Size (overall cartridge)	L x W x H: 4.92 in. x 4.29 in. x 1.00 in. (125mm x 109mm x 25.4mm)
Weight	9.17 oz. nominal (262g)
Cartridge Performance	
Number of Tracks	288 data tracks
Track Following Servo	Factory prerecorded Caution: do <b>not</b> bulk erase cartridges
Tape Speed	80 ips r/w, up to 440 ips search (2 m/s r/w, up to 11 m/s search)
Drop Test	Suitable for use after a drop of up to 39.4 in. (1m)*
Load/Unload	10,000 load/unloads minimum
Error Characteristics	
Permanent Errors	Zero
Archival Lifetime	15-30 years
Safety Characteristics	
Toxicity	Non-hazardous to human health in anticipated use
Flammability	Self-extinguishing per UL94
Environmental Recommendations	
Operating Conditions	Acclimate for 24 hours prior to use 60°F to 90°F (15°C to 32°C) 20% RH to 80% RH 78°F (26°C) wet bulb maximum
Storage Conditions (up to 4 weeks)	40°F to 90°F (-5°C to 32°C) 5% RH to 80% RH 78°F (26°C) wet bulb maximum
Archival Conditions (more than 4 weeks)	65°F to 79°F (18°C to 26°C) 40% RH to 60% RH 78°F (26°C) wet bulb maximum
Transportation Conditions	-10°F to 120°F (-23°C to 49°C) 5% RH to 80% RH 78°F (26°C) wet bulb maximum

\*As with all high capacity media, it is recommended that the data on a dropped cartridge be copied to another cartridge and the dropped cartridge be retired.

For more information about the Imation Black Watch™ 9840 Half-Inch Tape Cartridge, contact your authorized Imation dealer or sales representative.

[www.imation.com/9840](http://www.imation.com/9840)

#### WARRANTY

TEN YEAR LIMITED WARRANTY AND LIMITATION OF REMEDIES: Imation warrants that this product is free from defects in material and manufacture at the time of purchase. If any such defect appears within ten years from the date of purchase of the product, Imation's entire liability is, at Imation's option, either (a) repair, or (b) replacement of the product, or (c) refund of the purchase price of the product, which must be returned to Imation with proof of purchase. This warranty does NOT apply to product failure resulting from misuse, abuse, accident, neglect or mishandling, improperly adjusted or maintained drives, incorrect environments or wear and tear from ordinary use. WARRANTY IS VOID IF MEDIA INFORMATION REGION (MIR) IS OVERRITTEN OR CORRUPTED. IMATION SHALL NOT BE LIABLE FOR ANY INDIRECT, SPECIAL, INCIDENTAL OR CONSEQUENTIAL LOSS OR DAMAGE (INCLUDING WITHOUT LIMITATION DAMAGES FOR LOSS OF PROFITS, SAVINGS OR DATA) IN ANY WAY RELATED TO THE PRODUCT. This does not exclude claims for personal injury. Some states or countries do not allow the exclusion or limitation of incidental or consequential damages, so the above limitation or exclusion may not apply to you. This warranty gives you specific legal rights, and you may also have other rights which vary from state to state or country to country.